

SOUTH STAFFORDSHIRE DISTRICT COUNCIL

TOWN AND COUNTRY PLANNING GENERAL DEVELOPMENT ORDER 1988

WHEREAS the Council of the District of South Staffordshire being the appropriate local planning authority within the meaning of Article 4 of the Town and Country Planning General Development Order 1988 are of the opinion that development of the description set out in the Schedule hereto should not be carried out on land and premises within the South Staffordshire District being the land and premises shown edged red on the plan annexed hereto unless permission therefore is granted on application made under the Town and Country Planning General Development Order 1988.

AND WHEREAS the Council are further of the opinion that development of the said description would be prejudicial to the proper planning of their area and would constitute a threat to the amenities of their area and that the provisions of paragraph 4 of Article 5 of the Town and Country Planning General Development Order 1988 should apply to this direction.

NOW THEREFORE the said Council in pursuance of the powers conferred upon them by the said Article 4 hereby direct that the permission granted by Article 3 of the Town and Country Planning General Development Order 1988 shall not apply to development on the said land or premises of the description set out in the Schedule hereto.

THIS DIRECTION is made in pursuance of the provisions of paragraph 4 of the said Article and shall remain in force until 10th December (being six months from the date of this direction) and will then expire unless it has been approved by the Secretary of State for the Environment before that date.

SCHEDULE

The holding of markets within the South Staffordshire District at Blacklees Farm, Saredon, as shown edged red on the plan attached hereto being development comprised within Part 4 Class B referred to in Schedule 2 of the said Order and not being development comprised within any other class.

Dated this 10th day of June 1991

THE COMMON SEAL of the SOUTH STAFFORDSHIRE DISTRICT COUNCIL was hereunto affixed in the presence of:-

Chairman of the Council

Solicitor and Secretary

The Secretary of State for the Environment hereby approves the foregoing direction

Signed by authority
of the Secretary of
State

9 January 1992

A Regional
Controller in the
Department of the
Environment

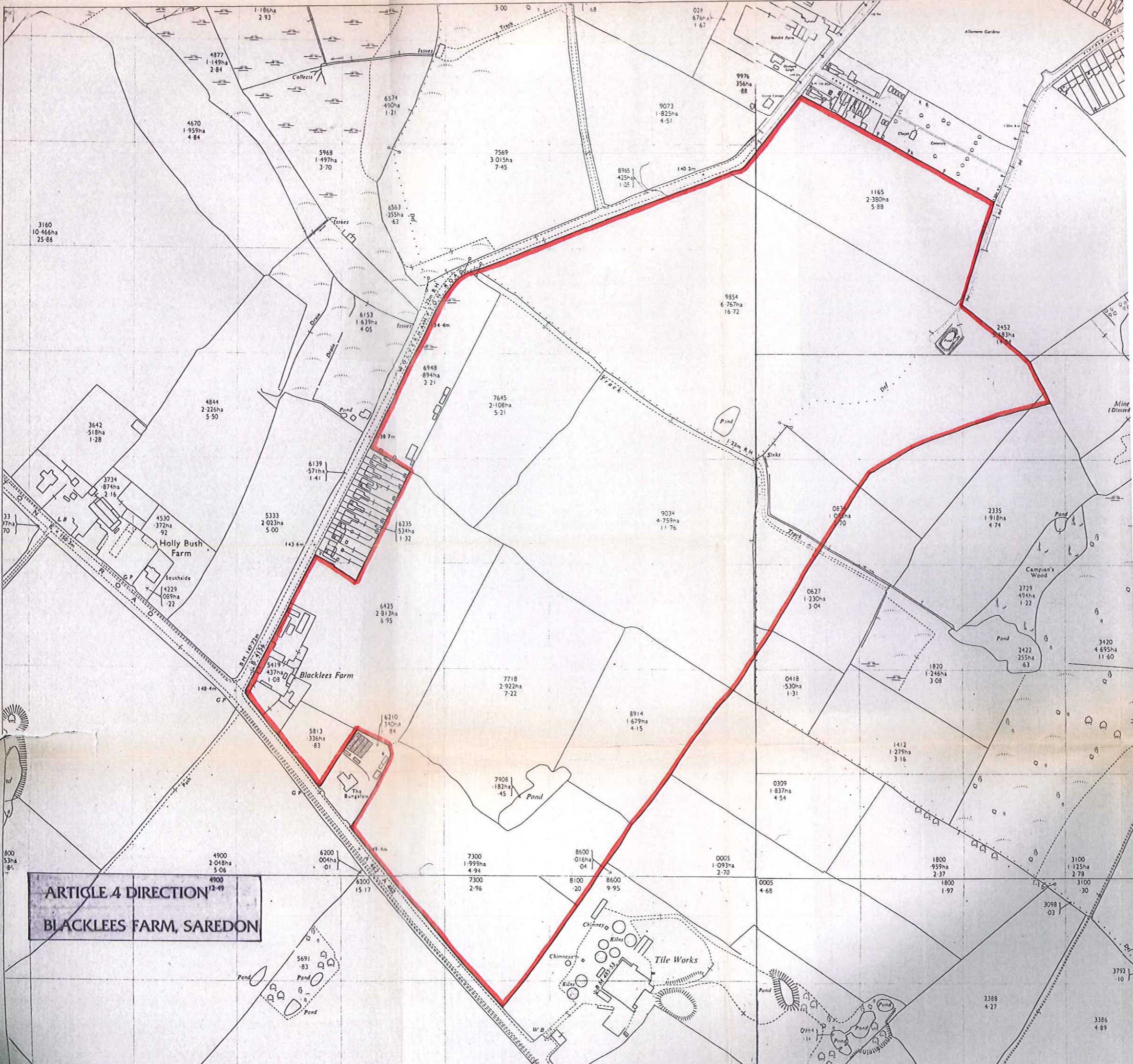

ARTICLE 4 DIRECTION
BLACKLEES FARM, SAREDON

1-186ha 2-93
4877 1-149ha 2-84
4670 1-959ha 4-84
3160 10-466ha 25-86
5968 1-497ha 3-70
6574 490ha 1-21
7569 3-015ha 7-45
8965 425ha 1-05
9073 1-825ha 4-51
9976 356ha 88
1165 2-380ha 5-88
2452 1-433ha 1-41
9854 6-767ha 16-72
6153 1-639ha 4-05
6948 894ha 2-21
7645 2-108ha 5-21
9034 4-759ha 11-76
2335 1-918ha 4-74
6139 571ha 1-41
6235 534ha 1-32
9034 4-759ha 11-76
0637 1-230ha 3-04
2335 1-918ha 4-74
2729 494ha 1-22
2422 255ha 63
3420 4-695ha 11-60
6425 2-813ha 6-95
7718 2-922ha 7-22
8914 1-679ha 4-15
0418 530ha 1-31
1830 1-246ha 3-08
1412 1-279ha 3-16
0309 1-837ha 4-54
5813 336ha 83
6210 340ha 84
7908 1-82ha 45
800 53ha 8
4900 2-048ha 5-06
6200 00ha 01
7300 1-999ha 4-94
7300 2-96
8100 20
8600 016ha 04
8600 9-95
0005 1-093ha 2-70
0005 4-68
1800 959ha 2-37
1800 1-97
3100 1-125ha 2-78
3100 30
3098 03
3792 10
2388 4-27
3386 4-89