

TOWN AND COUNTRY PLANNING
GENERAL PERMITTED DEVELOPMENT ORDER 1995

Direction made under Article 4(1) to which Article 5(4) applies

WHEREAS the Council of the District of South Staffordshire being the appropriate local planning authority within the meaning of article 4(6) of the Town and Country Planning (General Permitted Development) Order 1995, is satisfied that it is expedient that the development of the descriptions set out in the Schedule below shall not be carried out on land shown edged red on the attached plan, unless permission is granted on an application made under Part III of the Town and Country Planning Act, 1990.

AND WHEREAS the Council considers that development of the said descriptions would be prejudicial to the proper planning of this area and would constitute a threat to the amenities of their area and that the provisions of paragraph 4 of article 5 of the Town and Country Planning (General Permitted Development) Order 1995 apply.

NOW THEREFORE the said Council in pursuance of the power conferred on them by article 4(1) of the Town and Country Planning (General Permitted Development) Order 1995 hereby direct that the permission granted by article 3 of the said Order shall not apply to development on the said land of the descriptions set out in the Schedule below.

THIS DIRECTION is made under article 4(1) of the said order and in accordance with article 5(4) shall remain in force until 21st April, 2000 (being six months from the date of this direction) and shall then expire unless it has been approved by the Secretary of State for the Environment, *Transport and the Regions.*

SCHEDULE

The use of land adjacent to Beechwood Bonsai, off Wolverhampton Road, Prestwood (shown edged red on the attached plan) for not more than twenty eight days total in any calendar year for the sale of Christmas trees, being development comprised within Class B of Part 4 of Schedule 2 to the said Order and not being development comprised within any other class.

GIVEN UNDER THE COMMON SEAL of SOUTH STAFFORDSHIRE DISTRICT COUNCIL this 22nd day of October, 1999. the Common Seal of the Council was affixed to this direction in the presence of:-



Strategic Director
(Legal)

The Secretary of State for the Environment, Transport and the Regions confirms the above Order.

Signed by authority of the Secretary of State

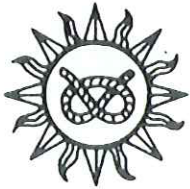

Senior Executive Officer
Government Office for the West Midlands

Date *13 March 2000*

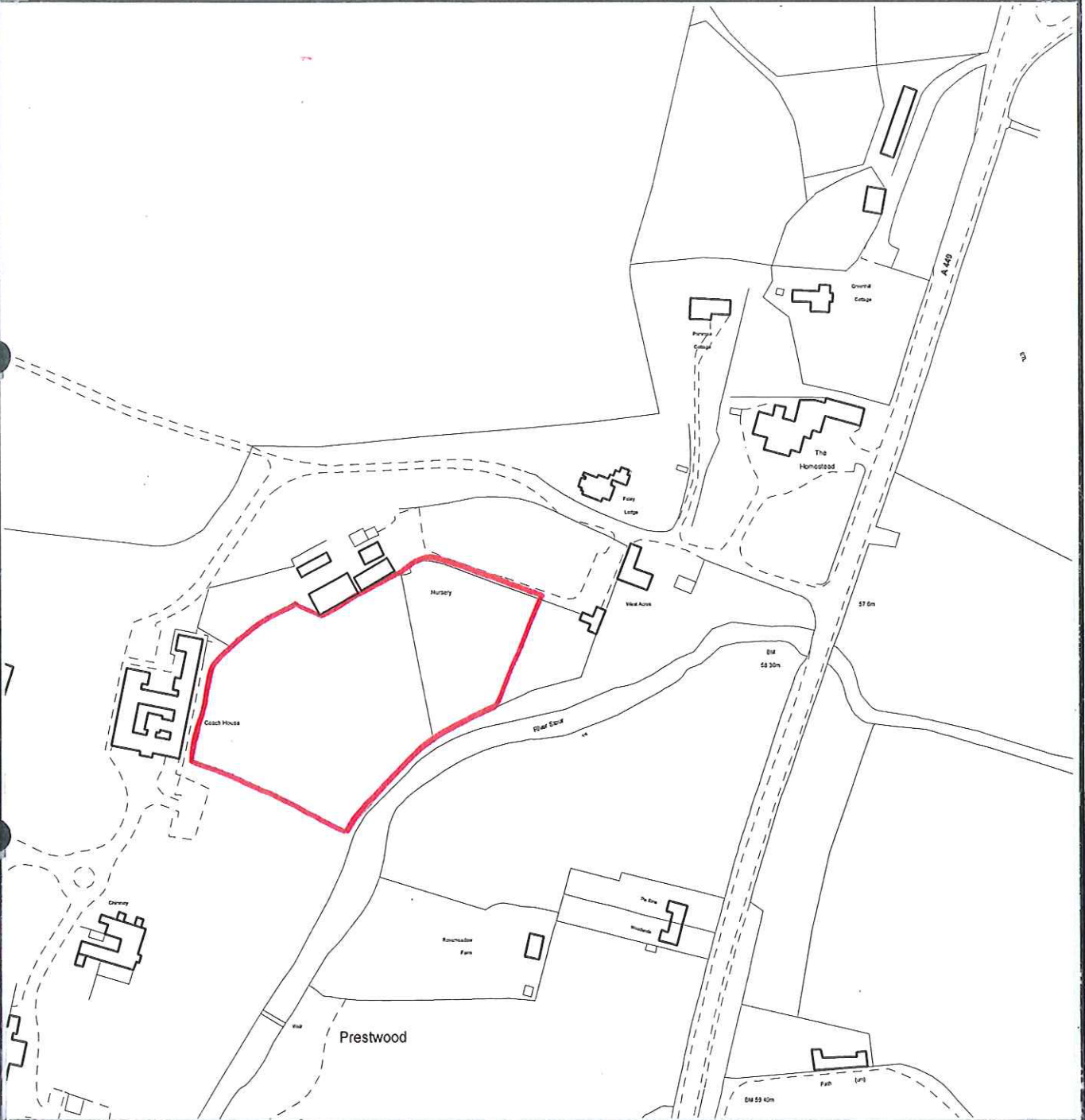

SOUTH STAFFORDSHIRE DISTRICT COUNCIL

Council Offices, Codsall, South Staffordshire WV8 1PX
Tel: (01902) 696000 Fax: (01902) 696403 DX: 18036



ARTICLE 4 DIRECTION

LAND ADJACENT TO BEECHWOOD BONSAI,
OFF WOLVERHAMPTON ROAD, PRESTWOOD.



NORTH
SCALE 1:2500

Reproduced from the Ordnance Survey Map with the sanction of the Controller of H.M. Stationery Office.
Crown Copyright Reserved.